

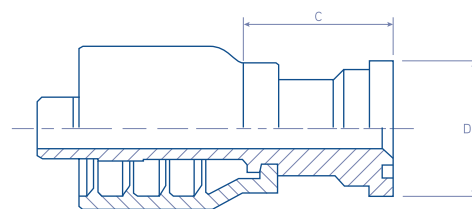

Straight SuperCAT Flange - SC



BW23.7116.

SAE J516 (CODE 62) / SAE J518 / ISO 12151-3

| REFERENCE | # | hose | | flange size | dimensions | |
|-------------|----------------|------|------|-------------|-------------|------|
| | | dash | inch | | C - Cut Off | D |
| BW2308-08SC | BW23.7116.0808 | 08 | 1/2" | 1/2" | 46,0 | 31,7 |
| BW2308-12SC | BW23.7116.0812 | 08 | 1/2" | 3/4" | 46,0 | 41,3 |
| BW2310-12SC | BW23.7116.1012 | 10 | 5/8" | 3/4" | 46,0 | 41,3 |
| BW2312-12SC | BW23.7116.1212 | 12 | 3/4" | 3/4" | 48,0 | 41,3 |
| BW2312-16SC | BW23.7116.1216 | 12 | 3/4" | 1" | 62,0 | 47,6 |
| BW2316-16SC | BW23.7116.1616 | 16 | 1" | 1" | 63,0 | 47,6 |
| BW2316-20SC | BW23.7116.1620 | 16 | 1" | 1.1/4" | 69,0 | 54 |

MATERIAL: Carbon Steel

FINISH: Chromium-(VI) Free plating /
ROHS compliant

Suitable to be used on medium and high pressure braided and spiral hoses:

FORZA UNO R1AT/1SN; FORZA UNO "SHARK SKIN" R1AT/1SN; FORZA UNO TROPIC R1AT/1SN;
FORZA DUE R2AT/2SN; FORZA DUE "SHARK SKIN" R2AT/2SN; FORZA DUE TROPIC R2AT/2SN;
BALPAC PREMIUM R16/2SC; BALPAC PREMIUM "SHARK SKIN" R16/2SC; BALPAC PREMIUM
TROPIC R16/2SC; IMPACTUS 5K; IMPACTUS 6K; BALPAC 3000 R17/1SC; BALPAC 3000 "SHARK
SKIN" R17/1SC; 2-MAX JACK; BALWASH 1W; BALWASH 2W; BALMASTER BESTFLEX R12;
BALMASTER BESTFLEX 4SP; POWERSPIR BESTFLEX 4SH; POWERSPIR BESTFLEX R13 (3/4" &
1"); POWERSPIR BESTFLEX R15 (3/4" & 1")