

# Straight SAE 6000 PSI Code 62 Flange - PH

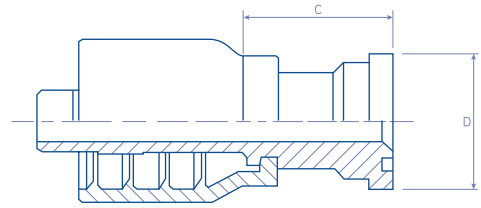

BW23.7016.

SAE J516 (CODE 62) / SAE J518 / ISO 12151-3

REFERENCE	#	hose		flange size	dimensions	
		dash	inch		C - Cut Off	D
BW2308-08PH	BW23.7016.0808	08	1/2"	1/2"	48,0	31,7
BW2308-12PH	BW23.7016.0812	08	1/2"	3/4"	51,0	41,3
BW2310-12PH	BW23.7016.1012	10	5/8"	3/4"	50,0	41,3
BW2312-12PH	BW23.7016.1212	12	3/4"	3/4"	52,0	41,3
BW2312-16PH	BW23.7016.1216	12	3/4"	1"	56,8	47,6
BW2316-16PH	BW23.7016.1616	16	1"	1"	56,7	47,6
BW2316-20PH	BW23.7016.1620	16	1"	1 1/4"	64,7	54
BW2320-20PH	BW23.7016.2020	20	1 1/4"	1 1/4"	65,0	54
BW2320-24PH	BW23.7016.2024	20	1 1/4"	1 1/2"	73,0	63,5
BW2324-24PH	BW23.7016.2424	24	1 1/2"	1 1/2"	75,0	63,5
BW2324-32PH	BW23.7016.2432	24	1 1/2"	2"	70,0	79,4
BW2332-32PH	BW23.7016.3232	32	2"	2"	87,6	79,4

**MATERIAL:** Carbon Steel

**FINISH:** Chromium-(VI) Free plating /  
ROHS compliant

## Suitable to be used on medium and high pressure braided and spiral hoses:

FORZA UNO R1AT/1SN; FORZA UNO "SHARK SKIN" R1AT/1SN; FORZA UNO TROPIC R1AT/1SN;  
FORZA DUE R2AT/2SN; FORZA DUE "SHARK SKIN" R2AT/2SN; FORZA DUE TROPIC R2AT/2SN;  
BALPAC PREMIUM R16/2SC; BALPAC PREMIUM "SHARK SKIN" R16/2SC; BALPAC PREMIUM  
TROPIC R16/2SC; IMPACTUS 5K; IMPACTUS 6K; BALPAC 3000 R17/1SC; BALPAC 3000 "SHARK  
SKIN" R17/1SC; 2-MAX JACK; BALWASH 1W; BALWASH 2W; BALMASTER BESTFLEX R12;  
BALMASTER BESTFLEX 4SP; POWERSPIR BESTFLEX 4SH; POWERSPIR BESTFLEX R13 (3/4" &  
1"); POWERSPIR BESTFLEX R15 (3/4" & 1")