

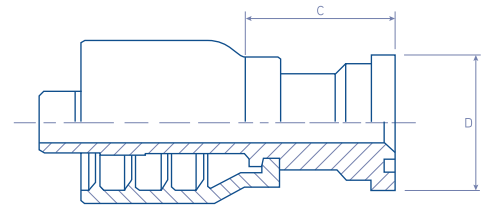

Straight SAE 3000 PSI Code 61 Flange - PA



BW23.7013.

SAE J516 (CODE 61) / SAE J518 / ISO 12151-3

REFERENCE	#	hose		flange size	dimensions	
		dash	inch		C - Cut Off	D
BW2308-08PA	BW23.7013.0808	08	1/2"	1/2"	47,0	30,2
BW2308-12PA	BW23.7013.0812	08	1/2"	3/4"	48,0	38,1
BW2310-10PA	BW23.7013.1010	10	5/8"	5/8"	58,0	34,0
BW2310-12PA	BW23.7013.1012	10	5/8"	3/4"	44,0	38,1
BW2312-12PA	BW23.7013.1212	12	3/4"	3/4"	48,8	38,1
BW2312-16PA	BW23.7013.1216	12	3/4"	1"	52,0	44,5
BW2316-16PA	BW23.7013.1616	16	1"	1"	56,0	44,5
BW2316-20PA	BW23.7013.1620	16	1"	1.1/4"	60,4	50,8
BW2320-20PA	BW23.7013.2020	20	1.1/4"	1.1/4"	57,0	50,8
BW2320-24PA	BW23.7013.2024	20	1.1/4"	1.1/2"	64,0	60,3
BW2324-20PA	BW23.7013.2420	24	1.1/2"	1.1/4"	67,0	50,8
BW2324-24PA	BW23.7013.2424	24	1.1/2"	1.1/2"	69,0	60,3
BW2324-32PA	BW23.7013.2432	24	1.1/2"	2"	70,0	71,4
BW2332-32PA	BW23.7013.3232	32	2"	2"	72,0	71,4

MATERIAL: Carbon Steel

FINISH: Chromium-(VI) Free plating /
ROHS compliant

Suitable to be used on medium and high pressure braided and spiral hoses:

FORZA UNO R1AT/1SN; FORZA UNO "SHARK SKIN" R1AT/1SN; FORZA UNO TROPIC R1AT/1SN;
FORZA DUE R2AT/2SN; FORZA DUE "SHARK SKIN" R2AT/2SN; FORZA DUE TROPIC R2AT/2SN;
BALPAC PREMIUM R16/2SC; BALPAC PREMIUM "SHARK SKIN" R16/2SC; BALPAC PREMIUM
TROPIC R16/2SC; IMPACTUS 5K; IMPACTUS 6K; BALPAC 3000 R17/1SC; BALPAC 3000 "SHARK
SKIN" R17/1SC; 2-MAX JACK; BALWASH 1W; BALWASH 2W; BALMASTER BESTFLEX R12;
BALMASTER BESTFLEX 4SP; POWERSPIR BESTFLEX 4SH; POWERSPIR BESTFLEX R13 (3/4" &
1"); POWERSPIR BESTFLEX R15 (3/4" & 1")