

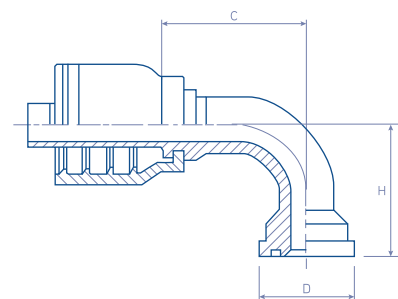

# 90° Elbow SAE 3000 PSI Code 61 Flange - PA90



BF21.7093.

SAE J516 (CODE 61) / SAE J518 / ISO 12151-3

REFERENCE	#	hose		flange size	dimensions		
		dash	inch		C - Cut Off	H	D
BF2108-08PA90	BF21.7093.0808	08	1/2"	1/2"	48,0	41,0	30,2
BF2108-12PA90	BF21.7093.0812	08	1/2"	3/4"	50,0	48,0	38,1
BF2110-12PA90	BF21.7093.1012	10	5/8"	3/4"	55,0	55,0	38,1
BF2112-12PA90	BF21.7093.1212	12	3/4"	3/4"	60,0	60,0	38,1
BF2112-16PA90	BF21.7093.1216	12	3/4"	1"	65,0	60,0	44,5
BF2116-16PA90	BF21.7093.1616	16	1"	1"	73,0	61,0	44,5

**MATERIAL:** Carbon Steel

**FINISH:** Chromium-(VI) Free plating /  
ROHS compliant

## Suitable to be used on medium and high pressure braided hoses:

FORZA UNO R1AT/1SN; FORZA UNO "SHARK SKIN" R1AT/1SN; FORZA UNO TROPIC R1AT/1SN; FORZA DUE R2AT/2SN; FORZA DUE "SHARK SKIN" R2AT/2SN; FORZA DUE TROPIC R2AT/2SN; BALPAC PREMIUM R16/2SC; BALPAC PREMIUM "SHARK SKIN" R16/2SC; BALPAC PREMIUM TROPIC R16/2SC; IMPACTUS 5K; IMPACTUS 6K; BALPAC 3000 R17/1SC; BALPAC 3000 "SHARK SKIN" R17/1SC; 2-MAX JACK; BALWASH 1W; BALWASH 2W