

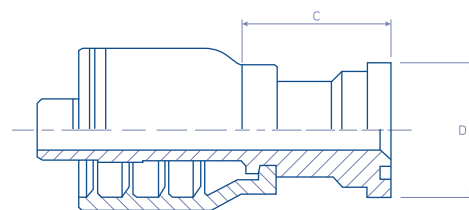

Straight SAE 3000 PSI Code 61 Flange - PA



BF21.7013.

SAE J516 (CODE 61) / SAE J518 / ISO 12151-3

REFERENCE	#	hose		flange size	dimensions	
		dash	inch		C - Cut Off	D
BF2108-08PA	BF21.7013.0808	08	1/2"	1/2"	47,0	30,2
BF2108-12PA	BF21.7013.0812	08	1/2"	3/4"	48,0	38,1
BF2110-10PA	BF21.7013.1010	10	5/8"	5/8"	58,0	34,0
BF2110-12PA	BF21.7013.1012	10	5/8"	3/4"	44,0	38,1
BF2112-12PA	BF21.7013.1212	12	3/4"	3/4"	48,8	38,1
BF2112-16PA	BF21.7013.1216	12	3/4"	1"	52,0	44,5
BF2116-16PA	BF21.7013.1616	16	1"	1"	56,0	44,5

MATERIAL: Carbon Steel

FINISH: Chromium-(VI) Free plating /
ROHS compliant

Suitable to be used on medium and high pressure braided hoses:

FORZA UNO R1AT/1SN; FORZA UNO "SHARK SKIN" R1AT/1SN; FORZA UNO TROPIC R1AT/1SN; FORZA DUE R2AT/2SN; FORZA DUE "SHARK SKIN" R2AT/2SN; FORZA DUE TROPIC R2AT/2SN; BALPAC PREMIUM R16/2SC; BALPAC PREMIUM "SHARK SKIN" R16/2SC; BALPAC PREMIUM TROPIC R16/2SC; IMPACTUS 5K; IMPACTUS 6K; BALPAC 3000 R17/1SC; BALPAC 3000 "SHARK SKIN" R17/1SC; 2-MAX JACK; BALWASH 1W; BALWASH 2W