

# Metric Banjo Bolt

88.1650.

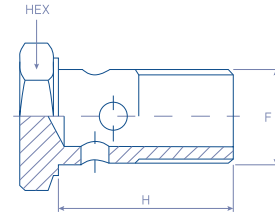

REFERENCE	F mm	H mm	HEX mm
88.1650.08	M8 x 1.0	16.0	12
88.1650.10	M10 x 1.0	19.0	14
88.1650.12	M12 x 1.5	23.0	17
88.1650.14	M14 x 1.5	25.0	19
88.1650.16	M16 x 1.5	31.0	22
88.1650.18	M18 x 1.5	36.0	24
88.1650.20	M20 x 1.5	38.0	27
88.1650.22	M22 x 1.5	38.0	27
88.1650.24	M24 x 1.5	41.0	30
88.1650.26	M26 x 1.5	46.0	32
88.1650.30	M30 x 1.5	58.0	38

**MATERIAL:** Carbon Steel

**FINISH:** Chromium-(VI) Free plating / ROHS compliant

# Metric Banjo Double Bolt

88.1652.

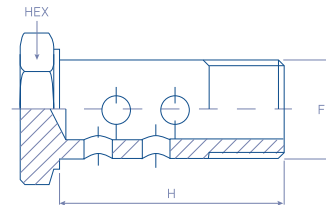

REFERENCE	F mm	H mm	Hex mm
88.1652.08	M8 x 1.0	29.0	12
88.1652.10	M10 x 1.0	33.0	14
88.1652.12	M12 x 1.5	37.0	17
88.1652.14	M14 x 1.5	43.0	19
88.1652.16	M16 x 1.5	51.0	22
88.1652.18	M18 x 1.5	57.0	24
88.1652.22	M22 x 1.5	63.0	27

**MATERIAL:** Carbon Steel

**FINISH:** Chromium-(VI) Free plating / ROHS compliant