

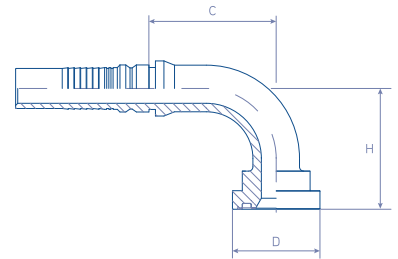

Interlock 90° Swept SAE 3000 PSI (code 61) Flange (SFL 90°)



26.7093.

ISO 6162-1 / ISO 12151-3 / SAE J516 / SAE J518

REFERENCE	hose dash	hose Ø inch	D Ø Flange mm	C Cut Off mm	H mm
26.7093.1212	-12	3/4"	38.1	63.0	56.5
26.7093.1216	-12	3/4"	44.5	58.0	58.0
26.7093.1616	-16	1"	44.5	75.0	65.0
26.7093.1620	-16	1"	50.8	67.5	61.0
26.7093.2020	-20	1.1/4"	50.8	83.7	69.2
26.7093.2024	-20	1.1/4"	60.3	82.3	69.2
26.7093.2424	-24	1.1/2"	60.3	109.0	90.0
26.7093.2432	-24	1.1/2"	71.4	109.0	104.0
26.7093.3232	-32	2"	71.4	145.0	123.0

MATERIAL: Carbon Steel

FINISH: Chromium-(VI) Free plating /
ROHS compliant

VERSIONS: Stainless Steel (add an 'S'
at the end of the REFERENCE)

Interlock Straight SAE 6000 PSI (code 62) Flange (SFS)

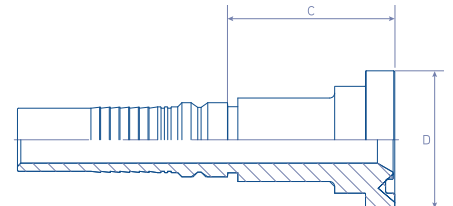

26.7016.

ISO 6162-1 / ISO 12151-3 / SAE J516 / SAE J518

REFERENCE	hose dash	hose Ø inch	D Ø Flange mm	C Cut Off mm
26.7016.1212	-12	3/4"	41.3	46.0
26.7016.1216	-12	3/4"	47.6	56.5
26.7016.1616	-16	1"	47.6	57.5
26.7016.1620	-16	1"	54.0	64.5
26.7016.2020	-20	1.1/4"	54.0	67.2
26.7016.2024	-20	1.1/4"	63.5	71.0
26.7016.2424	-24	1.1/2"	63.5	73.0
26.7016.2432	-24	1.1/2"	79.4	75.0
26.7016.3232	-32	2"	79.4	83.5

MATERIAL: Carbon Steel

FINISH: Chromium-(VI) Free plating /
ROHS compliant

VERSIONS: Stainless Steel (add an 'S'
at the end of the REFERENCE)