

Interlock Straight SAE 3000 PSI (code 61) Flange (SFL)

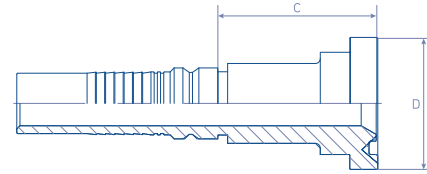

26.7013.

ISO 6162-1 / ISO 12151-3 / SAE J516 / SAE J518

REFERENCE	hose dash	hose Ø inch	D Ø Flange mm	C Cut Off mm
26.7013.1212	-12	3/4"	38.1	40.0
26.7013.1216	-12	3/4"	44.5	43.0
26.7013.1616	-16	1"	44.5	44.5
26.7013.1620	-16	1"	50.8	44.5
26.7013.2020	-20	1.1/4"	50.8	46.7
26.7013.2024	-20	1.1/4"	60.3	49.0
26.7013.2424	-24	1.1/2"	60.3	50.5
26.7013.2432	-24	1.1/2"	71.4	72.0
26.7013.3232	-32	2"	71.4	73.5

MATERIAL: Carbon Steel

FINISH: Chromium-(VI) Free plating / ROHS compliant

VERSIONS: Stainless Steel (add an 'S' at the end of the REFERENCE)

Interlock 45° Swept SAE 3000 PSI (code 61) Flange (SFL 45°)

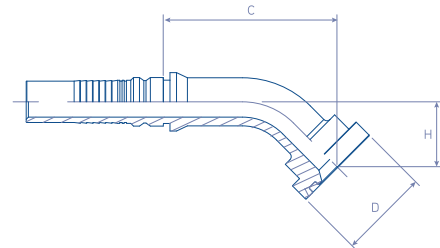

26.7043.

ISO 6162-1 / ISO 12151-3 / SAE J516 / SAE J518

REFERENCE	hose dash	hose Ø inch	D Ø Flange mm	C Cut Off mm	H mm
26.7043.1212	-12	3/4"	38.1	68.5	26.7
26.7043.1216	-12	3/4"	44.5	68.0	30.6
26.7043.1616	-16	1"	44.5	82.5	32.5
26.7043.1620	-16	1"	50.8	83.0	34.5
26.7043.2020	-20	1.1/4"	50.8	84.3	31.0
26.7043.2024	-20	1.1/4"	60.3	87.1	31.0
26.7043.2424	-24	1.1/2"	60.3	123.0	46.5
26.7043.2432	-24	1.1/2"	71.4	123.5	50.5
26.7043.3232	-32	2"	71.4	140.0	53.2

MATERIAL: Carbon Steel

FINISH: Chromium-(VI) Free plating / ROHS compliant

VERSIONS: Stainless Steel (add an 'S' at the end of the REFERENCE)