

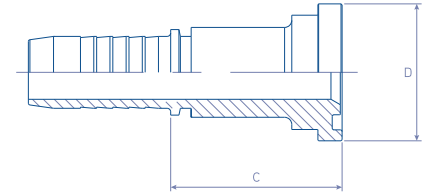

Straight SAE 3000 PSI (code 61) Flange (SFL)



23.7013.

ISO 6162-1 / ISO 12151-3 / SAE J516 / SAE J518

REFERENCE	hose dash	hose Ø inch	D Ø Flange mm	C Cut Off mm
23.7013.0808	-8	1/2"	30.2	40.0
23.7013.0812	-8	1/2"	38.1	42.0
23.7013.1010	-10	5/8"	34.0	37.0
23.7013.1012	-10	5/8"	38.1	45.0
23.7013.1212	-12	3/4"	38.1	45.0
23.7013.1216	-12	3/4"	44.5	48.0
23.7013.1616	-16	1"	44.5	50.0
23.7013.1620	-16	1"	50.8	54.0
23.7013.2020	-20	1 1/4"	50.8	55.0
23.7013.2024	-20	1 1/4"	60.3	60.0
23.7013.2424	-24	1 1/2"	60.3	60.0
23.7013.2432	-24	1 1/2"	71.4	65.0
23.7013.3232	-32	2"	71.4	66.0
23.7013.4040	-40	2 1/2"	84.1	90.0
23.7013.4848	-48	3"	101.6	91.0

MATERIAL: Carbon Steel

FINISH: Chromium-(VI) Free plating /
ROHS compliant

VERSIONS: Stainless Steel (add an 'S'
at the end of the REFERENCE)

NOTES: Although not in the SAE
or the ISO standard the size 34.0mm
(5/8) is according to JIS standard