

Female ORFS Swivel with Back Hexagon

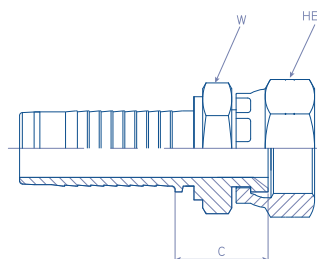

23.44H4.

ISO 12151-1 / ISO 8434-3 / SAE J516

REFERENCE	hose dash	hose Ø inch	thread inch	C cut off mm	W mm	HEX mm
23.44H4.0404	-4	1/4"	9/16" - 18	28.2	14	17
23.44H4.0406	-4	1/4"	11/16" - 16	31.7	17	22
23.44H4.0606	-6	3/8"	11/16" - 16	32.0	17	22
23.44H4.0608	-6	3/8"	13/16" - 16	35.0	19	24
23.44H4.0808	-8	1/2"	13/16" - 16	35.5	19	24
23.44H4.0810	-8	1/2"	1" - 14	41.5	24	30
23.44H4.0812	-8	1/2"	1.3/16" - 14	44.5	30	36
23.44H4.1010	-10	5/8"	1" - 14	42.5	24	30
23.44H4.1012	-10	5/8"	1.3/16" - 14	45.0	28	36
23.44H4.1212	-12	3/4"	1.3/16" - 14	45.6	30	36
23.44H4.1216	-12	3/4"	1.7/16" - 12	50.2	35	41
23.44H4.1616	-16	1"	1.7/16" - 12	50.7	35	41
23.44H4.1620	-16	1"	1.11/16" - 12	52.0	35	50
23.44H4.2020	-20	1.1/4"	1.11/16" - 12	54.5	41	50
23.44H4.2424	-24	1.1/2"	2" - 12	57.0	50	60

MATERIAL: Carbon Steel

FINISH: Chromium-(VI) Free plating / ROHS compliant

VERSIONS: Stainless Steel (add an 'S' at the end of the REFERENCE)