

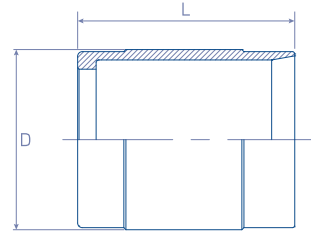

NON SKIVE Balfit® PTFE Convoluted Ferrule

20.TFC.



REFERENCE	hose dash	hose Ø		dimensions (mm)	
		mm	inch	L	D
20.TFC.08	- 8	12,7	1/2"	32.0	23.5
20.TFC.12	- 12	19,0	3/4"	43.0	32.0
20.TFC.16	- 16	25,4	1"	47.0	38.1
20.TFC.20	- 20	32,0	1-1/4"	59.0	46.0
20.TFC.24	- 24	38,0	1-1/2"	63.0	55.0
20.TFC.32	- 32	50,8	2"	70.0	69.0

MATERIAL: Carbon Steel

FINISH: Chromium-(VI) Free plating / **VERSIONS:** stainless steel AISI 316
ROHS compliant

Suitable to be used on PTFE hoses:

BALFLON CONVOLUTED; BALFLON CONVOLUTED BLACK CONDUCTIVE

NON SKIVE Balfit® 4 Spiral Ferrule

20.NS4.

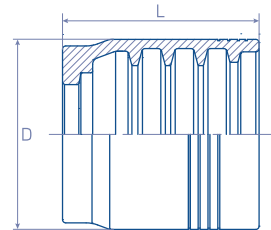

REFERENCE	hose dash	hose Ø		dimensions (mm)	
		mm	inch	L	D
20.NS4.06	- 6	9,5	3/8"	30.0	29.0
20.NS4.08	- 8	12,7	1/2"	33.5	33.0
20.NS4.10	- 10	16,0	5/8"	35.5	37.0
20.NS4.12	- 12	19,0	3/4"	40.0	42.0
20.NS4.16	- 16	25,4	1"	54.0	48.9
20.NS4.20	- 20	32,0	1-1/4"	61.0	61.0
20.NS4.24	- 24	38,0	1-1/2"	71.0	70.0
20.NS4.32	- 32	50,8	2"	88.0	84.8

MATERIAL: Carbon Steel

FINISH: Chromium-(VI) Free plating / **VERSIONS:** stainless steel AISI 316
ROHS compliant

Suitable to be used on high pressure 4 spiral hoses:

BALMASTER BESTFLEX 4SP; POWERSPIR BESTFLEX 4SH; BALMASTER BESTFLEX R12
POWERSPIR BESTFLEX R13 (DN20 -3/4" & DN25 - 1"); POWERSPIR BESTFLEX R15
(DN20 -3/4" & DN25 - 1")